

(A)

Bouha appartenant à un antiquaire de Montfort en Châlons.

bouh?

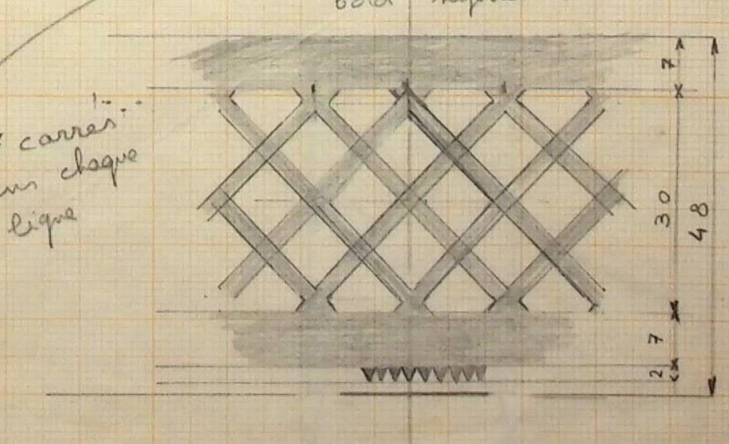

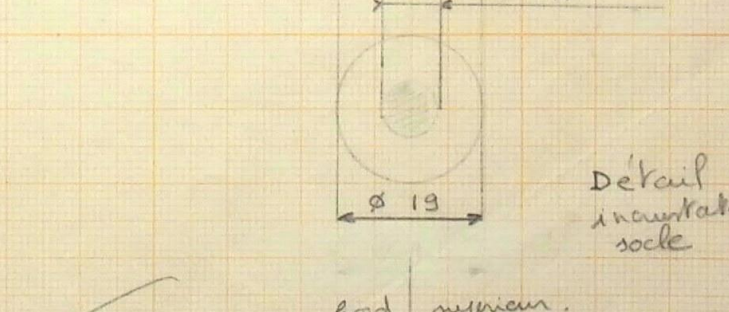
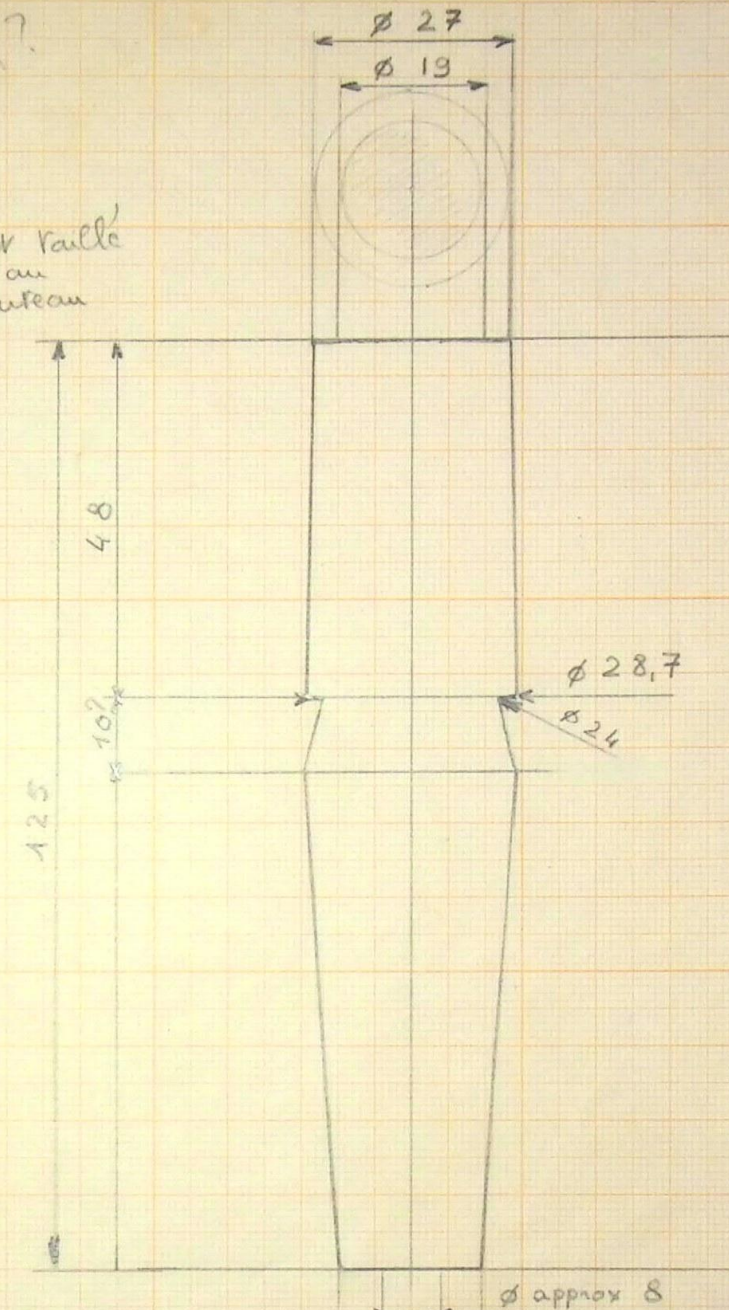
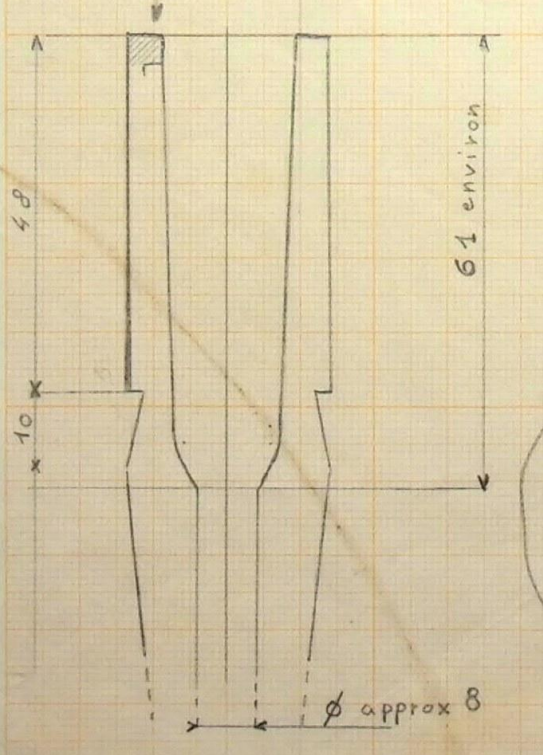
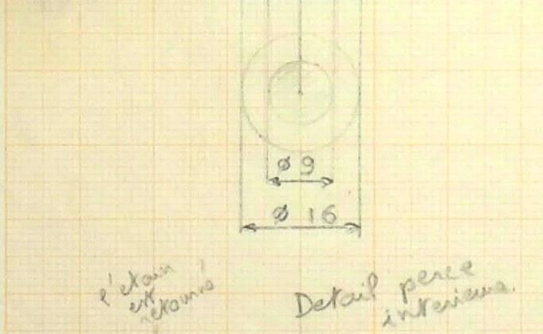
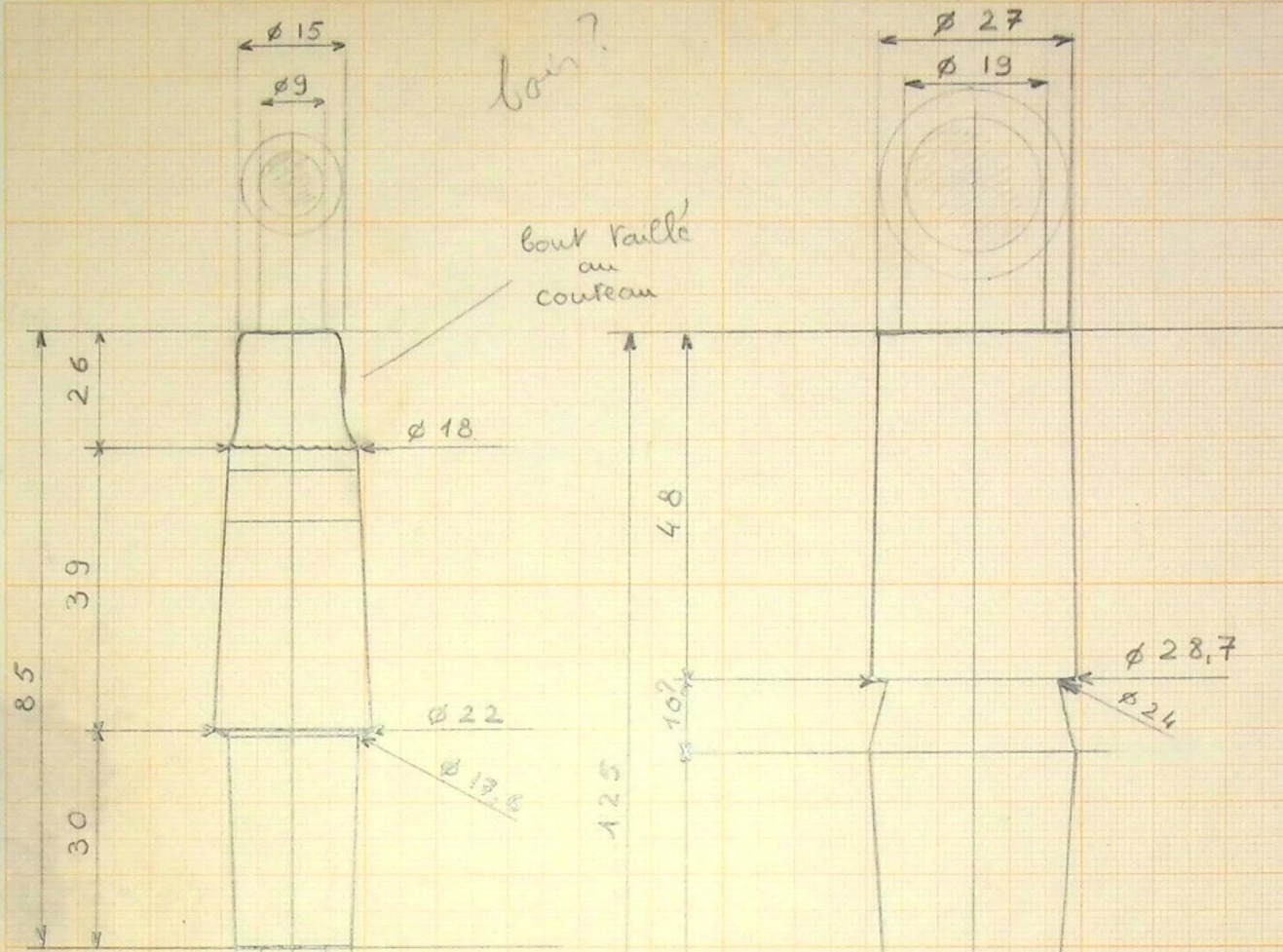

B

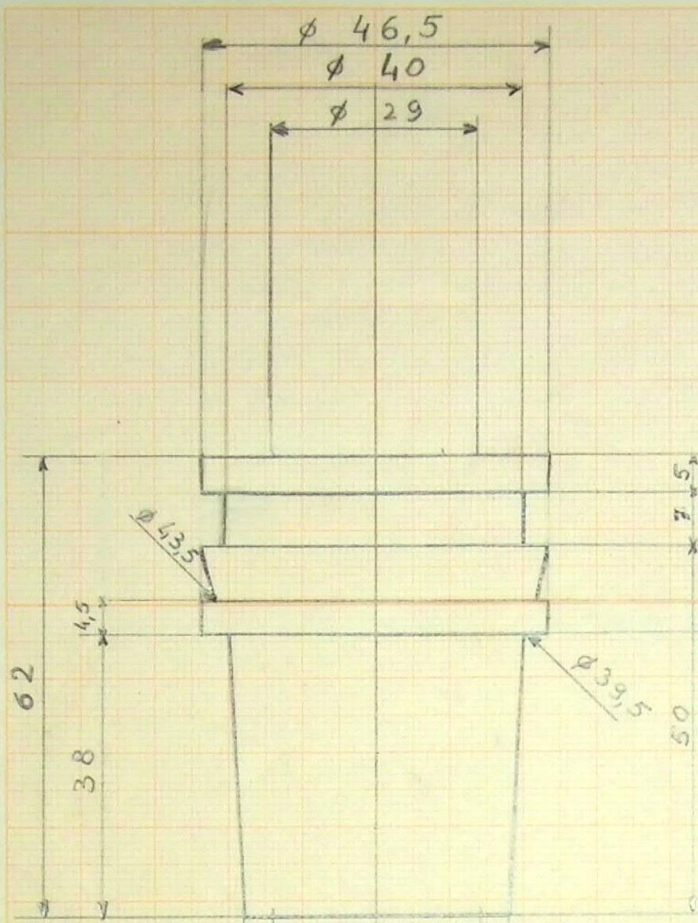

Detail sculpture sur  
1 mm de profondeur  
Petits triangles otés de  
environ 2,3 de base sur 2,5  
de haut

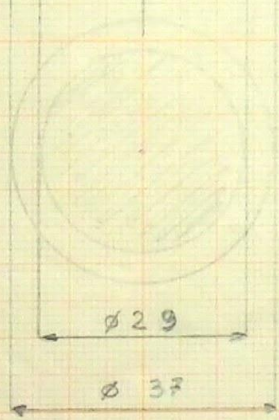
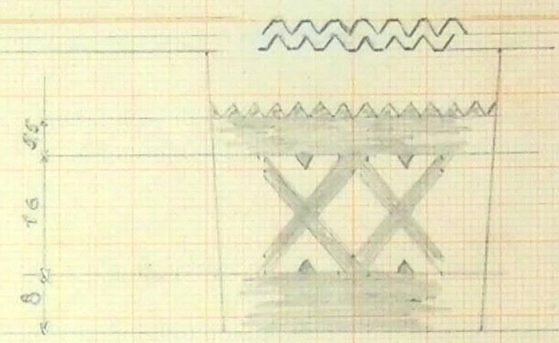

3 carrés intérieurs  
de diagonales horizontales  
variant entre 8 mm et 11 mm

Detail  
pauze  
interieur

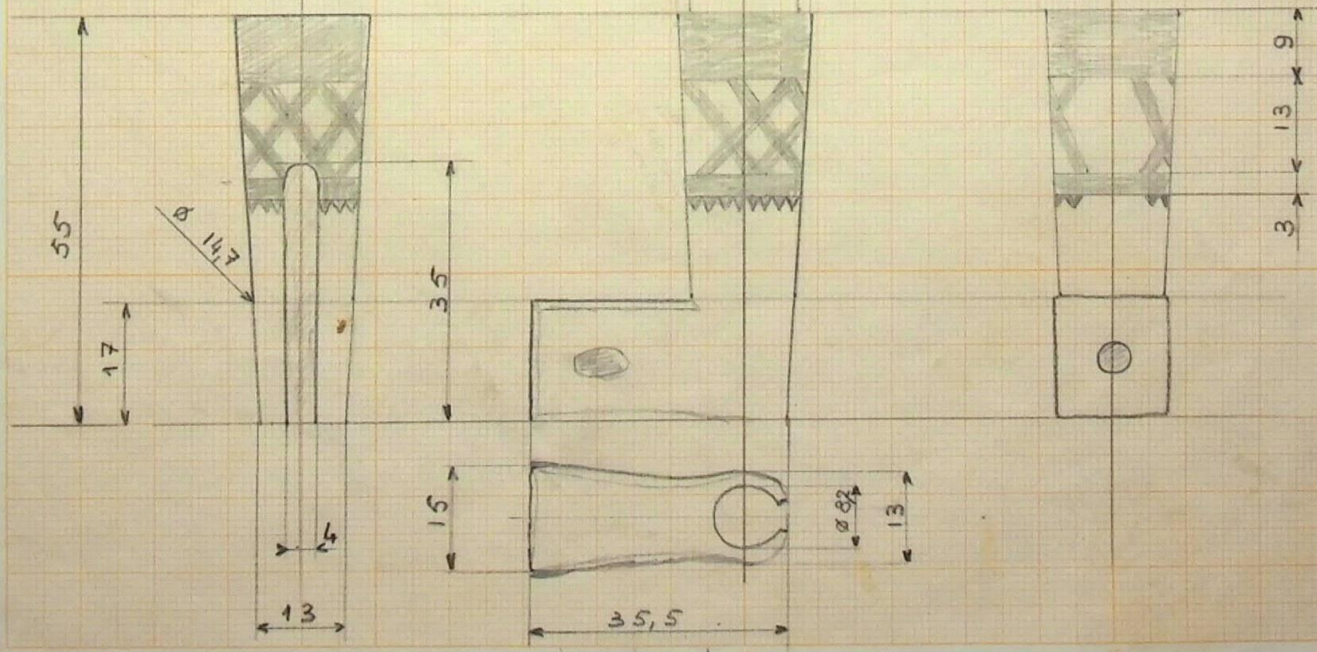
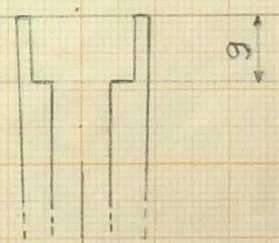



C

Detail piece en étain  
primitivement coulée sur l'habillage  
des anches et venue par deux  
queues d'arondes

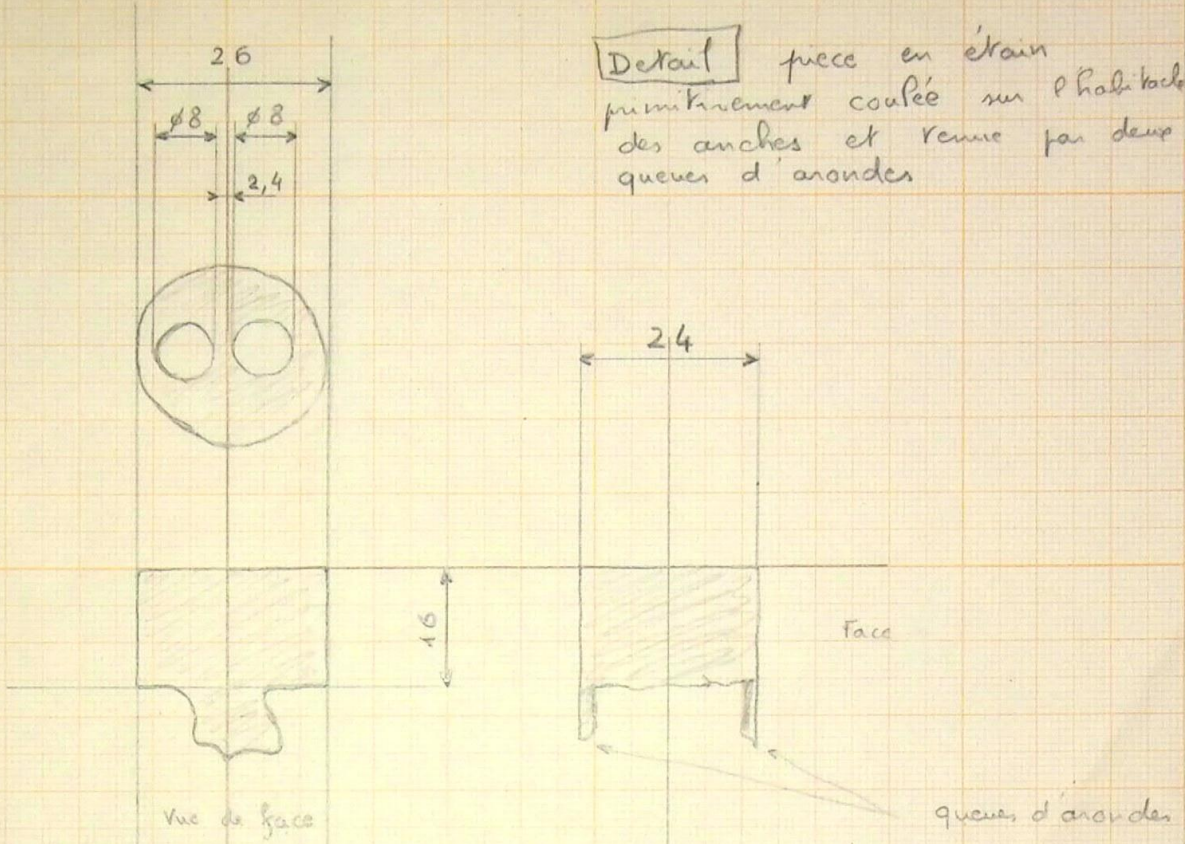

Detail habillage

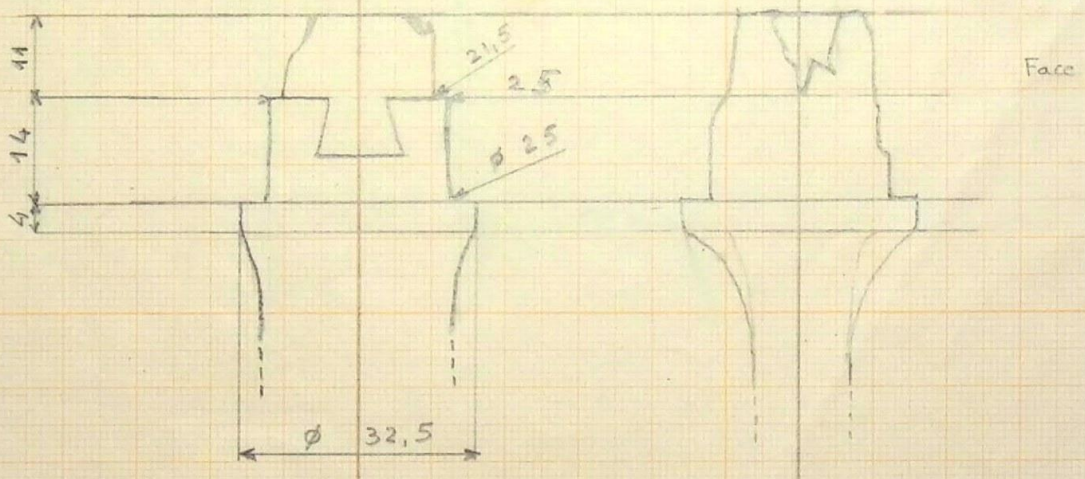

Detail montage

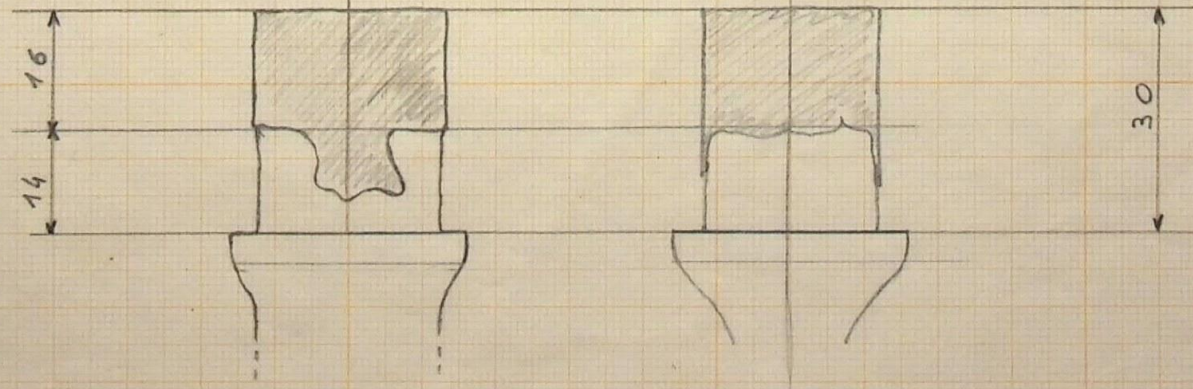



D

Perce intérieure  
a 8,1 mm presque 8,2 mm

159,3  
21,6  
137,7

26

3,5

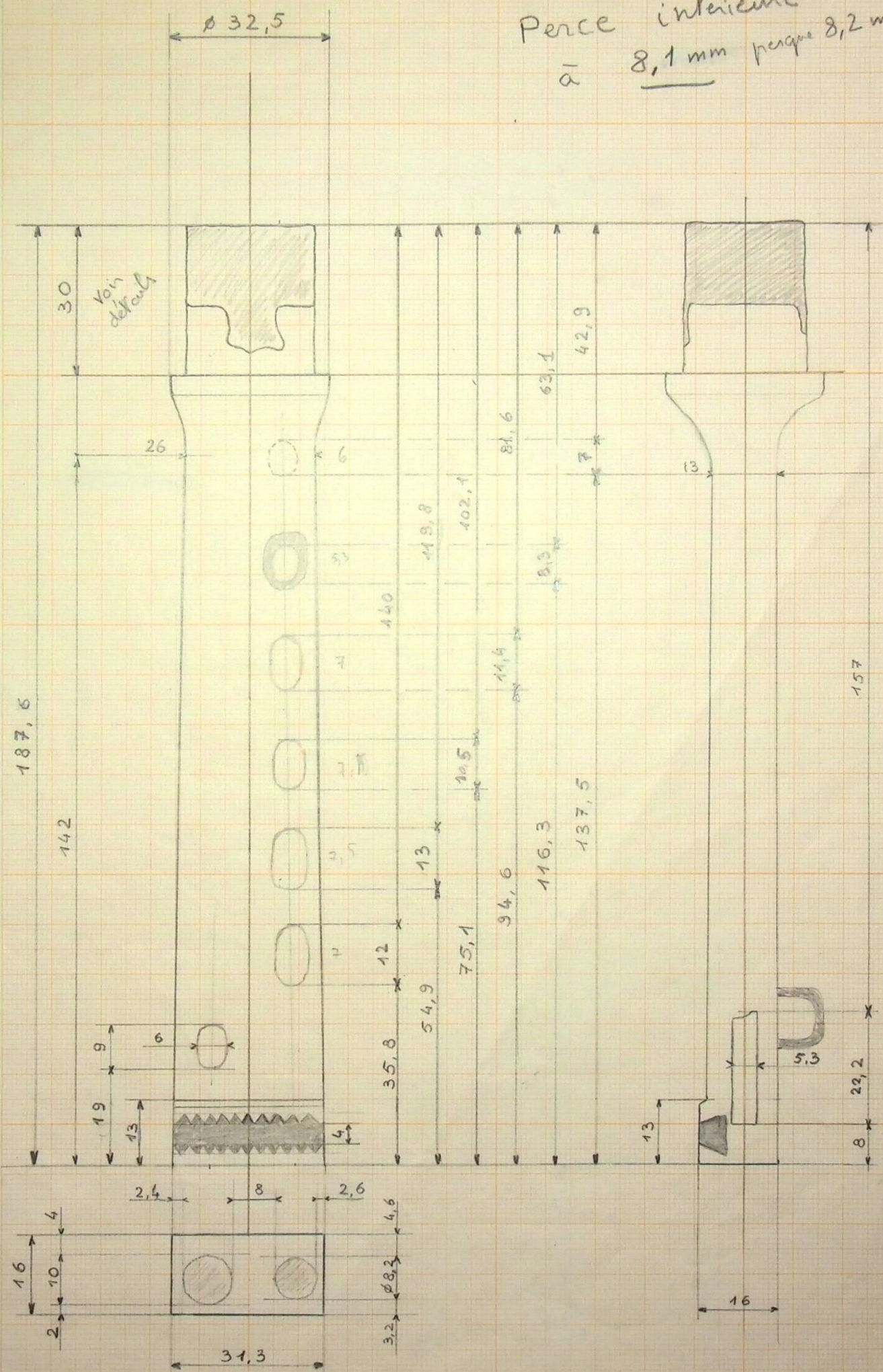



# Anches

Echelle 2

anche du Bowdon en meau  
du hautblais en roseau.

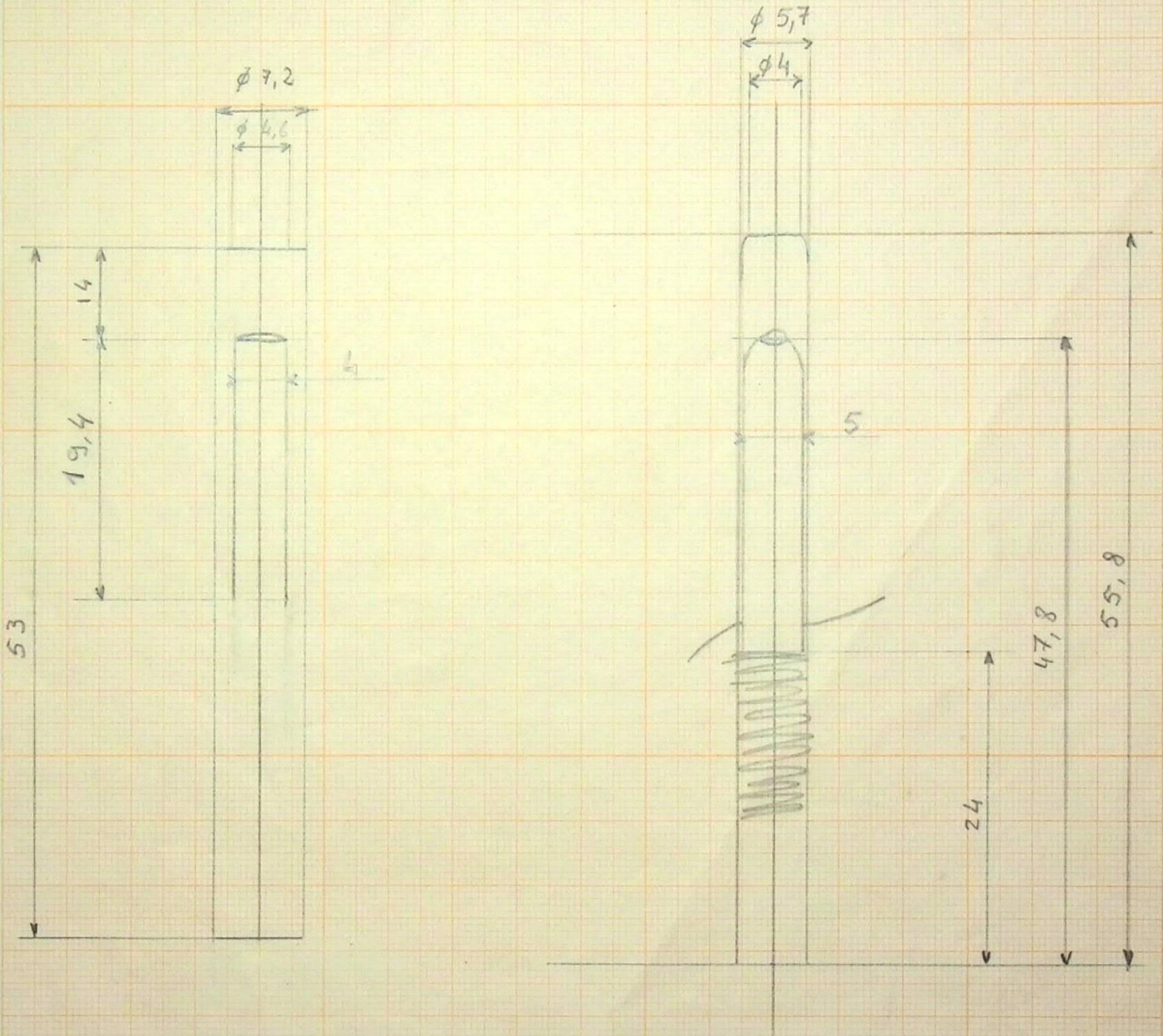

Bowdon